

AQUASONIC POOL SPEAKER

INSTALLATION GUIDE



GENERAL SAFETY INSTRUCTIONS

Thank you for purchasing the Aquasonic® AC339 from Clark Synthesis Tactile Sound. Please read the following instructions before assembling and using the product.

1. **DO NOT DROP SPEAKER** - If damage occurs due to high impact of speaker, it is not covered under warranty.
2. **Do not expose speaker to high distortion levels** - Excess distortion may result in failure. If speaker shuts down the built-in protection circuit is signaling that the volume level is too high. Turn the amplifier off for approximately 45 - 90 seconds to allow the speaker to reset. Operate at reduced volume. Continued use of high levels of distortion may cause speaker failure, which is not covered under the warranty.
3. **Use a ground fault interrupter** - A GFI outlet or extension cable on the sound system will prevent electrical shock in the event of a malfunction. These are available at hardware stores or home improvement stores. They are easy to install and provide a safe operating environment for your electronics and all pool users.
4. **Place speaker in pool away from diving boards and high activity areas** - Severe injury may result if speaker is contacted while diving or jumping.
5. **Cable placement** - Do not place cable in high traffic areas where people may trip or cable may tangle causing possible drowning or where pets may damage cable.
6. **Do not hang speaker by speaker cable** - Use a tether (nylon rope) tied to the eyelet on the speaker, and tie other end to a stationary anchor.
7. **Do not drag speaker on pool deck, bottom or side of pool** - This may damage speaker. This damage is not covered under the warranty.
8. **Do not remove or alter the watertight fitting from the speaker wire** - This fitting is set at the factory to seal out water. Over tightening may destroy the water-tight seal. Any physical alteration or damage will void the warranty.
9. **Avoid Excessive heat** - Do not leave the speaker in direct sunlight unless it is submerged in pool. High temperatures, as in a closed car, may result in damage and will void the warranty.
10. **The built-in protection circuit** - If the speaker shuts down, turn the amplifier off for approximately 45 - 90 seconds to allow the speaker to reset. Restart the amplifier at a lower volume. The protection circuit is triggered by excessive heat, distortion, or being overpowered. Continued overload of the protection circuit may cause speaker failure, which is not covered under the warranty. If symptoms persist the system may need to be configured differently. Contact Clark Synthesis or your local dealer for assistance.

INDEX OF CONFIGURATIONS



Portable Floating Model
Page 2



In-Wall Model
(Shown with Third-Party Light Niche)
Page 3



Portable Drop-In Model
Page 5

SUPPLIED/REQUIRED ITEMS

Supplied Parts

- A. (1 ea.) Aquasonic Transducer
- B. (1 ea.) Acoustic Sound Lens
- C. (3 ea.) Jam Nut
- D. (1 ea.) Stainless Steel Stud
- E. (2 ea.) Stainless Steel Washers
- F. (1 ea.) Acoustic Radiator
- G. (1 ea.) Float
- H. (4 ea.) Wire Floats
 - 100' Underwater Speaker Wire Cable
 - Installation Guide

Required Tools and Materials

- Third-Party Light Niche Part
- #2 Phillips Screwdriver
- (2 ea.) 9/16" Open-Ended Wrenches

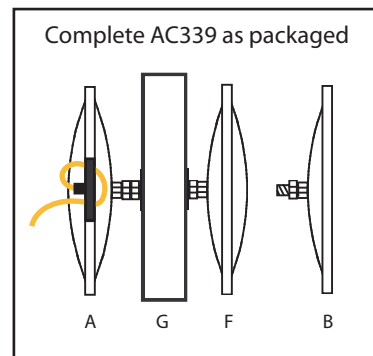

Carefully unpack product. DO NOT discard any parts or packaging until installation is complete.

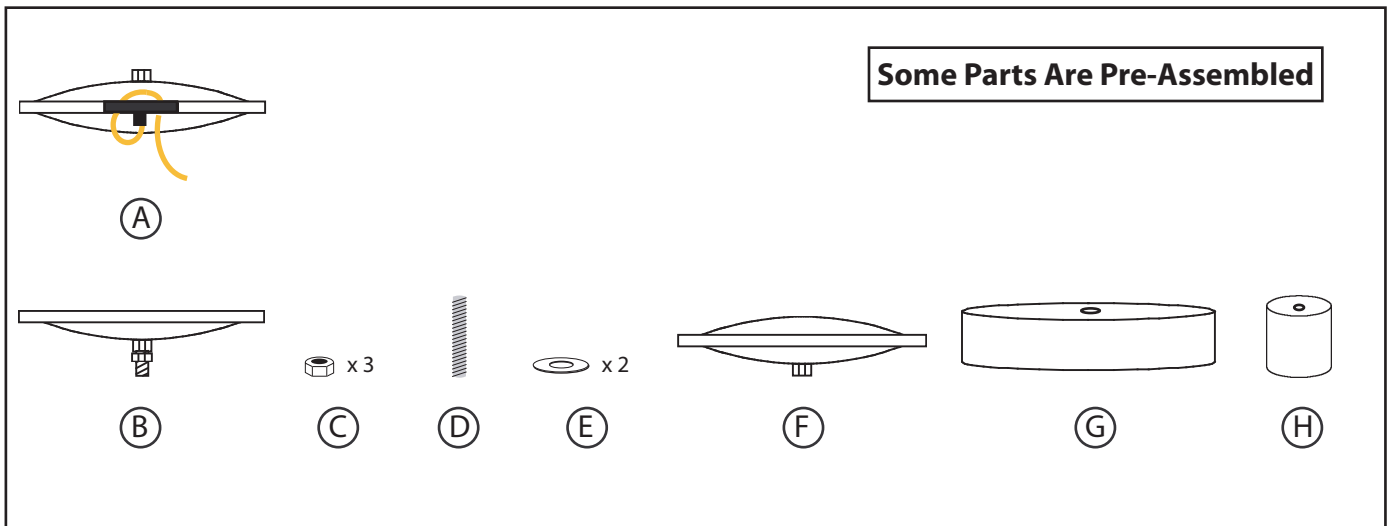

Required Audio Components

- Power: Receiver or amplifier for the TST. All AC339 configurations should be powered with between 100watts and 200watts. Make sure your amplifier is capable of driving a 4-ohm load.



AQUASONIC FLOATING INSTALLATION

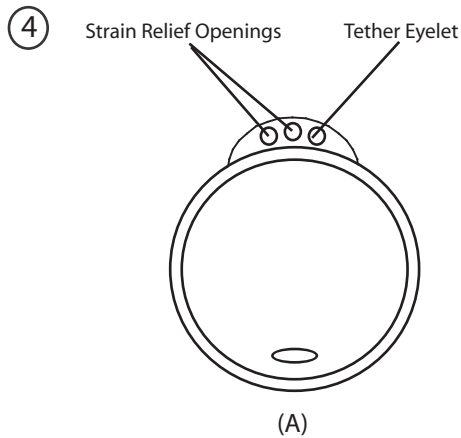
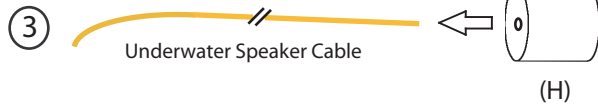

- ① Remove speaker from packaging.
- ② Remove wire floats (H) from top of styrofoam packing.
- ③ Slide wire floats onto the speaker wire, as needed.
- ④ Attach optional nylon rope of desired length to tether eyelet hole in rubber ring flange. Nylon rope can be purchased at pool supply or hardware store.
- ⑤ Hook up to stereo (135 watts into 4ohms is recommended).
- ⑥ Enjoy!

★ If speaker shuts off, turn off for approximately 45 seconds to allow internal protection circuit to reset. Turn down volume.

★ Use same underwater cable with waterproof connector to extend cable—extra cable available from Clark Synthesis.

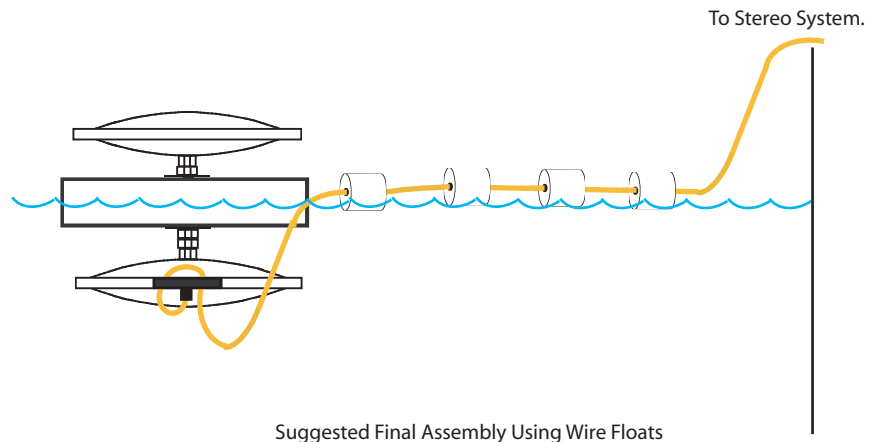



AQUASONIC IN-WALL INSTALLATION

This configuration requires some assembly. The Aquasonic® AC339 simply replaces the light bulb in the light niche.

TOOLS NEEDED: Phillips Head Screwdriver, 2-9/16" Open-Ended Wrenches.

Refer to Parts List on Page 2 For Corresponding Part Names.

- Remove AC339 and acoustic sound lens (B) from packaging.
- Separate the transducer (A) from the float (G). Using the 9/16" wrenches, loosen the jam nut to remove the float (G) assembly from the gold mounting point on the transducer (A). Use one 9/16" wrench to hold the transducer's (A) gold fastener, and with the second 9/16" wrench turn the jam nut away from the gold mounting point until float (G) and transducer (A) are separated.
- Remove one jam nut from the threaded stud on float (G) assembly. Thread jam nut completely onto stud attached to acoustic sound lens (B). You should now have two jam nuts threaded completely on to the stud connected to the sound lens (B).
- Fully thread acoustic sound lens (B) onto transducer (A). Using two wrenches tighten jam nut against the mounting point. Using one wrench to hold the transducer's (A) gold fastener, while the second tightens the jam nut against the gold mounting point. Make sure that jam nut is firmly tightened against the gold mounting point. This assembly is now ready for installing into a third-party light niche.

IMPORTANT NOTE: DO NOT ASSEMBLE BY USING THE DOME ITSELF TO TIGHTEN—MAKE SURE TO TIGHTEN THE TSTs BY USING A 9/16" WRENCH ON THE GOLD HEX MOUNTING POINT AND TURN THE JAM NUT USING A SECOND 9/16" WRENCH.

Please refer to page 5 for exploded diagram and part listing.

- Remove rubber gasket (#3) from a third-party light niche face ring assembly (#1) by loosening Phillips head screw on unitension wire clamp (#2).
- Wrap rubber gasket (#3) onto acoustic lens' (B) black rubber ring, then re-install (#3) with AC339 assembly installed into face ring (#1). Tighten unitension wire clamp (#2).
- Insert finished end of underwater speaker cable into conduit opening in back of light niche (#4). Thread wire through conduit to junction box.
- Insert complete assembly into light niche back can (#4) using pilot screw with captive gum washer (#5) to fasten chrome face ring assembly (#1) to finish installation.

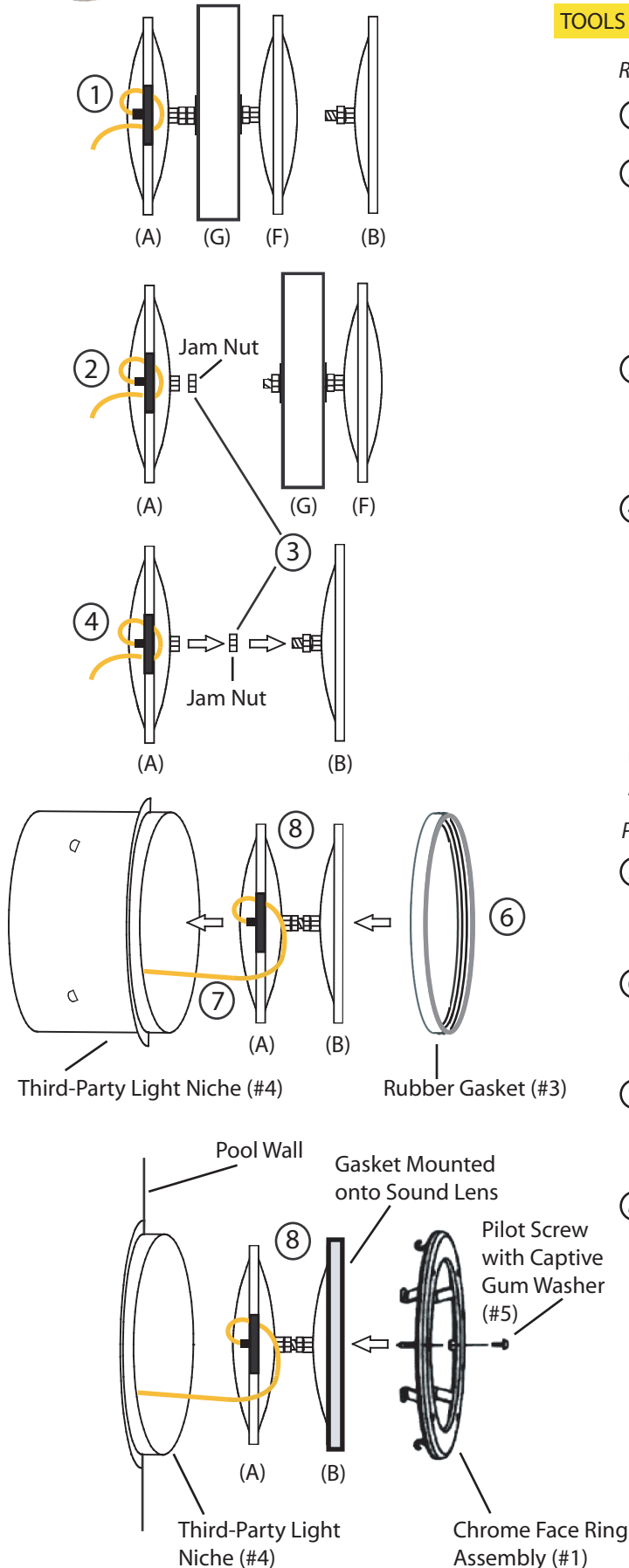



IN-WALL ASSEMBLY PARTS LIST

Parts Supplied By Third Party

| Item # | Part No. | Description |
|--------|----------|-------------------------------------|
| 1 | 79110600 | Face ring assembly, stainless steel |
| 2 | 79111000 | Unitension wire clamp assembly |
| 3 | 79101600 | Gasket for 8-3/8" lens |
| 4 | 00782105 | Light niche |
| 5 | 79104800 | Pilot screw with captive gum washer |

Parts Supplied By Clark Synthesis/Aquasonic

| Item # | Part No. | Clark Synthesis/Aquasonic Description |
|--------|----------|---------------------------------------|
| A | AC339 | Aquasonic underwater speaker (TST) |
| B | ASL339 | Clark Synthesis acoustic sound lens |
| C | LN002 | Lock nut (2) |
| D | SS-015 | Stainless steel stud |

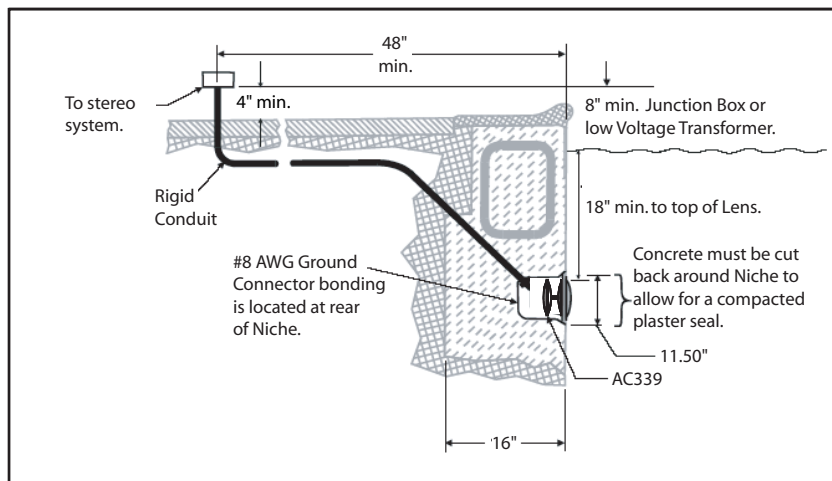
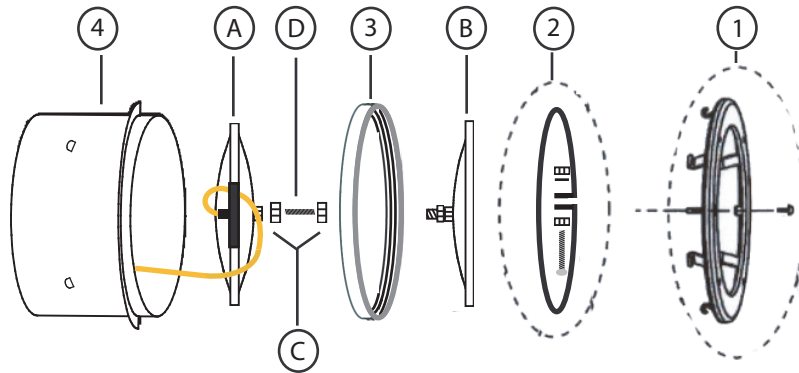



AQUASONIC DROP-IN INSTALLATION

This configuration requires some assembly. A tether is recommended to suspend speaker in water.

TOOLS NEEDED: Phillips Head Screwdriver, 2-9/16" Open-Ended Wrenches.

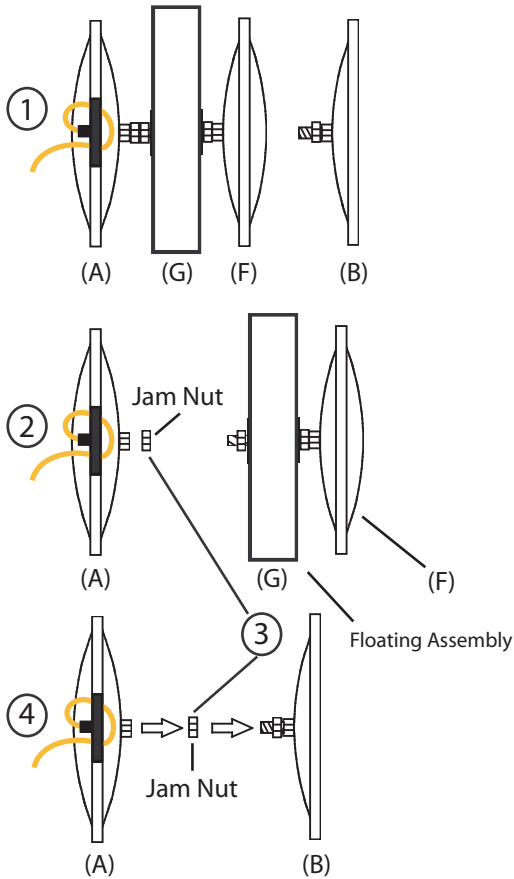

- ① Remove AC339 and acoustic sound lens (B) from packaging.
- ② Separate the transducer (A) from the float (G). Using the 9/16" wrenches, loosen the jam nut to remove the float (G) assembly from the gold mounting point on the transducer (A). Use one 9/16" wrench to hold the transducer's (A) gold fastener, and with the second 9/16" wrench turn the jam nut away from the gold mounting point until float (G) and transducer (A) are separated.
- ③ Remove one jam nut from the threaded stud on float (G) assembly. Thread jam nut completely onto stud attached to acoustic sound lens (B). You should now have two jam nuts threaded completely on to the stud connected to the sound lens (B).
- ④ Fully thread acoustic sound lens onto transducer (A). Using two wrenches tighten jam nut against the mounting point. Using one wrench to hold the transducer's (A) gold fastener, while the second tightens the jam nut against the gold mounting point. Make sure that jam nut is firmly tightened against the gold mounting point. This assembly is now ready to have a tether attached and be lowered into water.

IMPORTANT NOTE: DO NOT ASSEMBLE BY USING THE DOME ITSELF TO TIGHTEN—MAKE SURE TO TIGHTEN THE TSTs BY USING A 9/16" WRENCH ON THE GOLD HEX MOUNTING POINT AND TURN THE JAM NUT USING A SECOND 9/16" WRENCH.

- ⑤ Attach nylon rope* (not supplied) to tether eyelet.
- ⑥ Use wire floats (H) as needed.

* Recommended option: A tether (nylon rope) is recommended to use to raise, lower, and suspend speaker in water—this can be purchased at your local hardware or pool supply store.

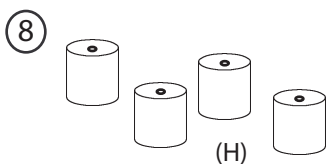
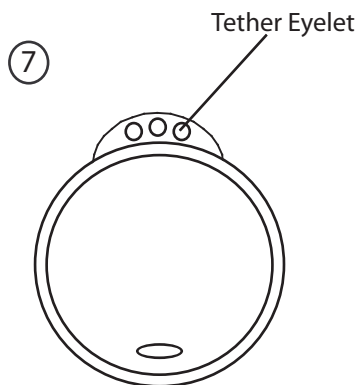



United States Warranty and Return Policy

AC339-AQUASONIC POOL SPEAKER WARRANTY

Clark Synthesis, Inc. warrants the AC339-Aquasonic Pool Speaker to be free from defects and workmanship under normal use for a period of one (1) year from date of original purchase. For industrial or commercial use, the warranty period is six (6) months.

Should warranty service be necessary, Clark Synthesis, Inc. will (at its discretion) repair or replace the defective merchandise with equivalent merchandise at no charge.

This warranty is valid for the original purchaser and is not extended to subsequent owners. Any applicable implied warranties are limited in duration to a period of the express warranty as provided herein beginning with the date of the original purchase at retail, and no warranties, whether expressed or implied, shall apply to this product thereafter. Some states do not allow limitations on implied warranties; therefore these exclusions may not apply to you. This warranty gives you specific legal rights; however, you may have other rights that vary state to state.

WHAT IS NOT COVERED

This warranty is valid only if the product is used for the purpose for which it was designed. It does not cover the following:

- Damage caused by excessive heat
- Damage through negligence, misuse, accident, or abuse
- Damage caused by incorrectly mounting the speaker
- Damage due to not using an appropriate amplifier
- Freight damage
- Items previously repaired by unauthorized repair facility
- Items damaged due to amplifier clipping and/or distortion
- Items returned from unauthorized individuals or dealers
- Cost of shipping product to Clark Synthesis, Inc.
- Return shipping on non-defective items

RETURN POLICY

New, unused items purchased from us may be returned within 7 days of the purchase date. Please note: Clark Synthesis will only accept returns for items that are received in their original packaging, in undamaged and re-sellable (new) condition. Manuals, accessories, warranty cards, and everything else that came with the unit must be included as well. If your return does not meet these conditions, you will be charged a 15% restocking fee or have the merchandise returned to you at your expense. Non-defective merchandise can also be returned for a 15% restocking fee. Shipping charges for all non-defective returns or exchanges are not refundable.

WHAT TO DO IF YOU NEED WARRANTY OR SERVICE

If it becomes necessary for you to return defective merchandise call Clark Synthesis Customer Service at (303) 797-7500, and you will be given a Return Authorization Number. Follow the instructions provided by our customer service staff, use suitable packing materials (preferably the original shipping boxes), and make sure to write your Return Authorization Number on the outside of your box when sending your return to us. Orders that are returned without an Return Authorization Number may be refused by our returns department!

Remember to include a dated proof of purchase from an authorized dealer. Freight must be prepaid: items received freight collect will be refused.

Make sure that the following is included in your package:

- Product to be returned
- Repacked in original shipping containers
- Return Authorization Number printed on the outside of the box
- Copy of original invoice with Return Authorization Number printed on it

Return to our Service Department:

RA#: _____

Clark Synthesis, Inc.
8020 Southpark Circle, Suite 600
Littleton, Colorado 80120

INTERNATIONAL WARRANTY

Contact your International Clark Synthesis dealer or distributor concerning specific procedures for your country's warranty policies.